



Quick Start Instructions
United Kingdom

Summary

Introduction	3
Step 1: Connect your equipment	4
Step 2: Do the DVDR setup	11
Step 3: Do the GUIDE Plus+ setup	12
Step 4: Leave your DVDR on standby overnight	14
Step 5: Next Day - Check your listings & your channel lineup	16
Alternate Setup	18
Notes	20

Introduction

These instructions will help you complete both your first-time DVDR installation as well as the initial setup of the GUIDE Plus+® system.

The GUIDE Plus+ system works by receiving programme information data from specific channels "Host Channels" (1) that carry the data in each country. To work properly, the GUIDE Plus+ system must be able to recognize your DVDR equipment configuration and the host channel for your location.

This information is entered during the GUIDE Plus+ Setup process. The GUIDE Plus+ Setup must be completed after you done the basic installation of your equipment.

► (1) Host Channels p. 20

Step 1: Connect your equipment

Make sure your equipment is configured properly so that the GUIDE Plus+ system inside your DVDR can interact correctly with your other equipment.

No External Receiver:

1. Insert your aerial cable into the Antenna IN socket at the back of your DVDR.
 - a. If terrestrial: connect to terrestrial antenna.
 - b. If analogue cable: connect to cable source.
2. Plug one end of the Scart cable into the Scart socket at the back of your DVDR and the other end into the corresponding Scart socket at the back of your TV.

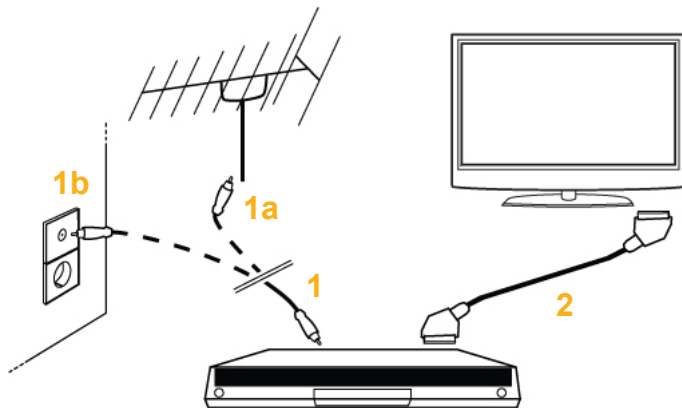

With External Receiver:

1. Plug one end of the first Scart cable into the Scart socket at the back of your DVDR and the other end into the corresponding Scart socket at the back of your TV set.
2. Plug one end of the second Scart cable into the second socket at the back of your DVDR and the other end into the corresponding Scart socket at the back of your external receiver.
3. Connect your external receiver:
 - a. If digital terrestrial: to terrestrial antenna through your DVDR (Antenna IN/OUT socket).
 - b. If cable: to cable source.
 - c. If satellite: to satellite dish.
4. Connect the plug of the G-LINK® cable to the back of the DVDR and place the other end in front of the external receiver so that its infrared detector can receive a clear signal. (2) ⓘ

ⓘ **There may be devices from some manufacturers which do not include a G-LINK transmitter. Without a G-LINK transmitter, the GUIDE Plus+ system will not be able to control the tuner of your external receiver!**

► (2) Note p. 20

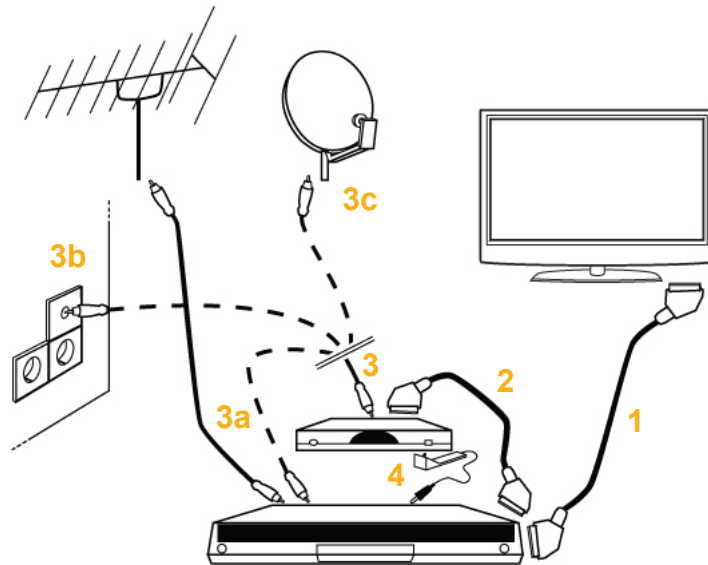

With External Receiver - Two Different Sources:

In some exceptions it might be best to connect your equipment to two different sources. For example you might want to use a digital satellite or digital cable receiver for some channels and an aerial for other channels. Depending on your region it might be necessary to receive your Host Channel via aerial (see also Step 4 and Step 5).

1. Insert your aerial cable into the Antenna IN socket at the back of your DVDR.
2. Plug one end of the first Scart cable into the Scart socket at the back of your DVDR and the other end into the corresponding Scart socket at the back of your TV set.
3. Plug one end of the second Scart cable into the second socket at the back of your DVDR and the other end into the corresponding Scart socket at the back of your external receiver.
4. Connect your external receiver:
 - a. If digital terrestrial : to your DVDR, into the antenna OUT socket at the bottom of your DVDR. **(1)**
 - b. If cable: to cable source.
 - c. If satellite: to satellite dish.
5. Connect the plug of the G-LINK® cable to the back of the DVDR and place the other end in front of the external receiver so that its infrared detector can receive a clear signal. **(2)** **(i)**

► (2) Note p. 20, (i) p. 10

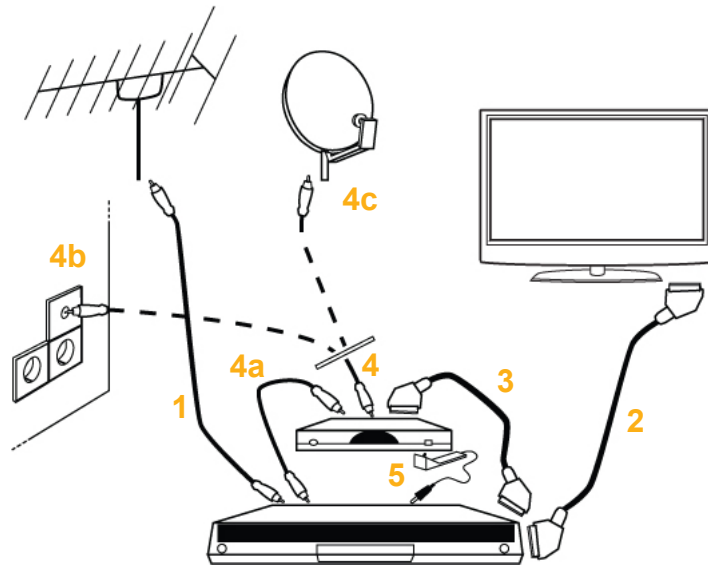

ⓘ 1 *If you only have one wall outlet you can either use a “splitter” or connect your DVDR to the wall outlet and your external receiver to the Antenna OUT socket of your DVDR. There is a “loop through” between Antenna IN and OUT and therefore delivers the same result as a splitter.*

ⓘ 2 *There may be devices from some manufacturers which do not include a G-LINK transmitter. Without a G-LINK transmitter, the GUIDE Plus+ system will not be able to control the tuner of your external receiver!*

Step 2: Do the DVDR setup

Before you can do the GUIDE Plus+ setup you must complete the setup of your DVDR. When you switch your DVDR “ON” for the first time you will be guided through the installation process with on-screen prompts. For more details consult the chapter on installation of your DVDR in your Instruction Manual. For the GUIDE Plus+ system to work properly for your region, you must select the following options correctly during your DVDR setup:

- Language
- Country

Both values will be transferred to the GUIDE Plus+ Setup area automatically.

In addition it is important to note that your DVDR scans for your receivable channels during the setup process. Again, the channel scan results will be transferred to the GUIDE Plus+ system automatically.

Step 3: Do the GUIDE Plus+ setup

In order to receive the correct GUIDE Plus+ programme data you must set up the GUIDE Plus+ system to recognize your equipment configuration and your geographic location.

- Press the “Guide” button on your remote control. The GUIDE Plus+ Setup area appears.
- Language and Country settings have already been entered automatically by the DVDR setup.
- Select Postal Code and enter your postal code using the remote control number pad. **(3)**
- External Receiver: If you use an external receiver you will have to set it up for the GUIDE Plus+ system. **(4)**
 - Select External Receiver 1, 2, or 3, to identify your first external box. **(5)**
 - Select your reception (terrestrial, cable or satellite).
 - Select a provider if applicable.
 - Select the brand of your external receiver.
 - Identify which socket your external receiver is plugged into (EXT 1, 2 or 3, or CAM 1 or 2). Here, you must identify the actual socket. **(6)**
 - If the external receiver changed channels correctly confirm with “yes” exit the Setup area by pressing the “Guide” button on the remote control and go to Step 4. If not, or if your receiver brand is not included in the on-screen

► **(3) (4) (5) (6)** Notes p. 21

list, continue the setup process (Step 4) and read ALTERNATE SETUP at the end of this document.

Step 4: Leave your DVDR on standby overnight

The GUIDE Plus+ system must receive the first download of programme information overnight. It will wake up automatically, tune to your Host Channel (1) and start receiving updated GUIDE Plus+ data.

No External Receiver:

During a pre-defined timeslot in the early morning hours, the GUIDE Plus+ system automatically scans all your receivable channels to identify the correct Host Channel for your location.

In order to receive data correctly we recommend that you leave your DVDR in standby overnight.

With External Receiver:

If you use an external receiver the GUIDE Plus+ system cannot automatically scan all the channels that you receive via this external receiver. In this case you have to manually tune your external receiver to your Host Channel.

In order to receive data correctly we recommend that you:

- Tune your external receiver to your Host Channel and
- Leave your external receiver "ON" overnight (if your external receiver is

► (1) Host Channels p. 20

"OFF" the GUIDE Plus+ system cannot receive any data)

- Leave your DVDR in standby overnight

External Receiver with Two Different Sources:

If you use two different sources (e.g. an analogue terrestrial antenna and an external receiver) we recommend that you first follow the process described above under "No external receiver". If you are still not able to receive data, manually tune to your Host Channel as described under "With External Receiver".

ⓘ All other actions like recording or watching have priority over the scanning. Therefore it is important to leave your DVDR in standby (not "ON"). All future downloads will happen automatically as long as your DVDR is in standby mode overnight.

Step 5: Next Day - Check your listings & your channel lineup

Verify that your GUIDE Plus+ Setup was completed successfully with the correct channel lineup & programme information.

- Press the “Guide” button on your remote control to access the Grid. If the guide is populated with channel logos and programme information, then your first data download was completed successfully. The GUIDE Plus+ channel lineup for each country/region represents the list of most commonly received channels, in the most commonly expected order.
- Cursor up and down the listings to review your channel lineup. If certain channels are missing, or if you see channels that you do not receive, go to the Editor screen.
- Cursor through the channel list and follow the on-screen prompts to turn channels “ON” or “OFF” according to what you receive in your home. (7)
- Use the remote control number keys to change the programme numbers to match your TV’s settings and/or your preferences. (8) ⓘ
- When you are done, press Home to start using the GUIDE Plus+ system.

ⓘ ***The definition of the programme number affects the number that is displayed on screen when viewing a particular channel, and importantly also identifies the source channel that is recorded during timer-set recordings.***

▶ (7) (8) Notes p. 22

YOU ARE DONE!

You are now ready to start enjoying your DVDR with the GUIDE Plus+ system built-in.

Alternate Setup

Use these steps if you could not complete successfully External Receiver Setup in Step 3

If your external receiver is not in the list (9) or if your external receiver could not be controlled properly by the DVDR, please follow these steps:

- For External Receiver brand, Select “none” (at the end of the list).
- Exit the Setup area and the GUIDE Plus+ system by pressing the “Guide” button on your remote control.
- Leave your DVDR on standby,
- Tune your external receiver to your Host Channel and leave it “ON” overnight. It will wake up automatically and start receiving updated GUIDE Plus+ data from the Host Channel.

Next Day

The next day, go back into the GUIDE Plus+ Setup area to finish installing your external receiver:

- Press the “Guide” button on your remote control.
- Use the arrow keys to access the menu bar.
- Use the right arrow button to reach the Setup area.
- Then use the down arrow to select Setup.
- Go to the External Receiver field in the Setup area and continue the installation:
 - Select External Receiver 1, 2, or 3, to identify your first external box.
 - Select your reception (terrestrial, cable or satellite).
 - Select a provider if applicable.
 - Select the brand of your external receiver (it will now be included in the on-screen list).
 - Identify which socket your external receiver is plugged into (EXT 1, 2 or 3, or CAM 1 or 2).
 - If the external receiver changed channels correctly confirm with “yes” and exit the Setup area by pressing the “Guide” button on your remote control.
- Go to Step 4 and 5 to finish the initial installation of your GUIDE Plus+ system.

Notes

► (1) Host Channels

► www.europe.guideplus.com > Help > Countries & Host Channels

Austria	Eurosport
Belgium	RTL-TVI
France	Canal +
Germany	Eurosport
Italy	MTV
Netherlands	Eurosport
Luxembourg	RTL-TVI
Spain	Tele 5
Switzerland (German speaking region)	Eurosport
United Kingdom	ITV (terrestrial), Eurosport

i **When editing your channel list in the Editor area, please do NOT turn your host channel “OFF”. If you do, you will not receive the automatic daily listings updates.**

► (2) G-LINK allow you to control the tuner of the receiver through the GUIDE Plus+ system.

► To find the infrared detector in your receiver: use the receiver’s remote control and move it slowly from left to right in front of the receiver’s front

panel while pressing any channel button. If you see a red blinking light or if the receiver switched to the channel you entered, then you have located the infrared detector. Alternatively, you can use a flash light and look behind the glass screen of the receiver’s front panel. The infrared detector looks like a small red light bulb.

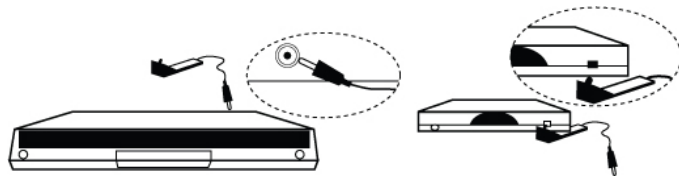

► (3) The postal code you enter must be correct, and must represent a postal code in the identified country. If it is not correct or does not match the country, you will receive incomplete guide data, incorrect data or no data at all.

► (4) If you do not use an external receiver, leave the fields as they are with “none” indicated. Then exit the Setup area (and the GUIDE Plus+ system) by pressing the “Guide” button on the remote control and go to Step 4.

► (5) This is just an on-screen label; it does not need to match the socket into which the box is actually plugged.

▶ **(6)** The DVDR will now try to communicate with the external receiver via the G-LINK cable. The on-screen prompt will ask you if the receiver changed to a specified channel.

▶ **(7)** Channels that are turned “ON” will be displayed in the listings. Channels that are turned “OFF” will not be displayed.

▶ **(8)** For each channel that is turned “ON” the GUIDE Plus+ system needs to know how it is received (its source) and on which programme number. This is also done in the Editor screen. The source may be the tuner or an External Receiver. The programme number is the number on which the channel is found on its receiving device/source.

▶ **(9)** The list of external receivers controllable by the GUIDE Plus+ system is updated constantly and is distributed through the GUIDE Plus+ system's data signals. Since the time your DVDR has been manufactured and the time you install your DVDR for the first time, new external receiver codes might have been added.

 Check our website: www.europe.guideplus.com > Help > Supported External Receivers to see our current list of supported receivers. If your receiver is listed here, its appropriate control data is currently in the data feed, and will be received by your device. If you don't see your External Receiver on the list, call your manufacturer's Customer Support Centre. (See [your Instruction Manual](#) for locations and phone numbers)

GUIDE Plus+ is a registered trademark of
Gemstar-TV Guide International, Inc.

